

Lower Ground Floor

Gallery

Bastow School Photographic display all taken in early 1880s to illustrate school architecture.

Bastow Theatre

This theatre has a capacity of 100 people and features impeccable acoustics, executive style seating, superior technology interconnectivity, and video conferencing between other learning spaces and by remote and local lecturers/presenters. There are 3 main displays, audio conferencing via microphones built into desks, multi-channel surround sound, and video conferencing facilities.

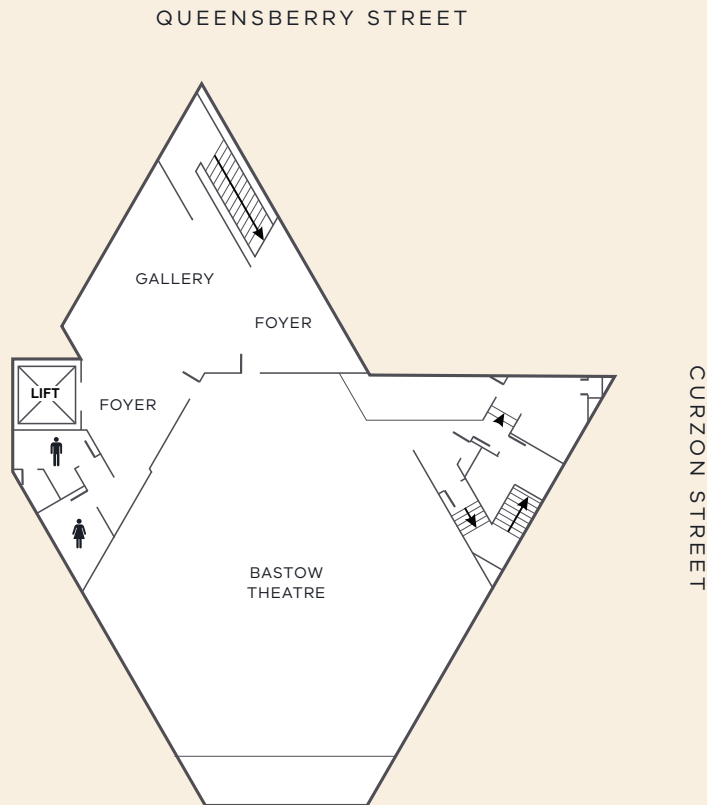

Ground Floor

E5 Studio

Our E5 Studio is equipped with a 1-way glass observational booth and includes recording and editing facilities. The purpose of this space is to support the observation of teacher and leadership practice – this helps our program participants analyse their teaching activities.

Dewey Common Room

Named after John Dewey – philosopher and educational reformer in 19th and 20th century, the Dewey Common is perfectly designed for workshops, meetings or formal functions.

Pathway of Learning

The wooden imprinted pathway of learning represents the journey that educational leadership has taken, through key theorists.

Plato Terrace

Named after one of philosophy's most notable icons, the Plato Terrace is a space to relax and reflect.

Message stick

Mounted in the pebble eucalypt garden in the Plato Terrace, tells the story of welcoming visitors to Wurundjeri land.

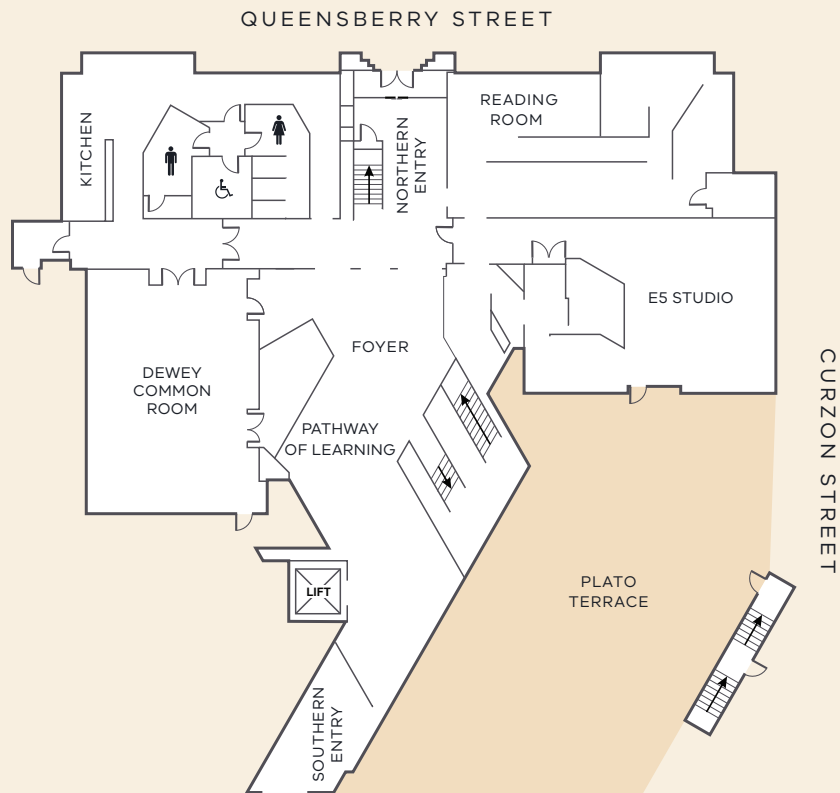

Level One

Bastow stairwell

The grand stairwell is a feature of many Bastow schools and adds to the ecclesiastical atmosphere of Bastow's schools – located within the building's tower.

Syndicate Rooms 1-4

Four syndicate spaces, two per room. Ideally suited for break out activities and small group workshops or meetings. Note the textured wall made from recycled bottles.

Teaching lounge

One of the Informal learning spaces that aligns to the mission and the design of the building, to promote the creative use of spaces and technology to support learning.

