

# Ground Floor

## Readers' Room

The Readers' Room is one of the quieter spaces in the building, designed to have a library feel, it is a destination where users can work on independent research, study, and investigation.

The bluestone areas were completed in 1857.

## Recording studios

The Recording Studios enable the Academy to be a centre for excellence in school teaching and leadership, including podcasting and video recordings.

Formerly the Clerical Branch, which ensured that the Office's 500 staff were a well-oiled machine and work was executed to a high standard.

## Columbian Rooms

Named after the original printing press used in this building, the multi-functional Columbian Rooms are where many of the Academy's professional learning takes place.

Formerly the Lithographic Branch, producing the finest maps in Australia, and gold mining licences during the gold rush.

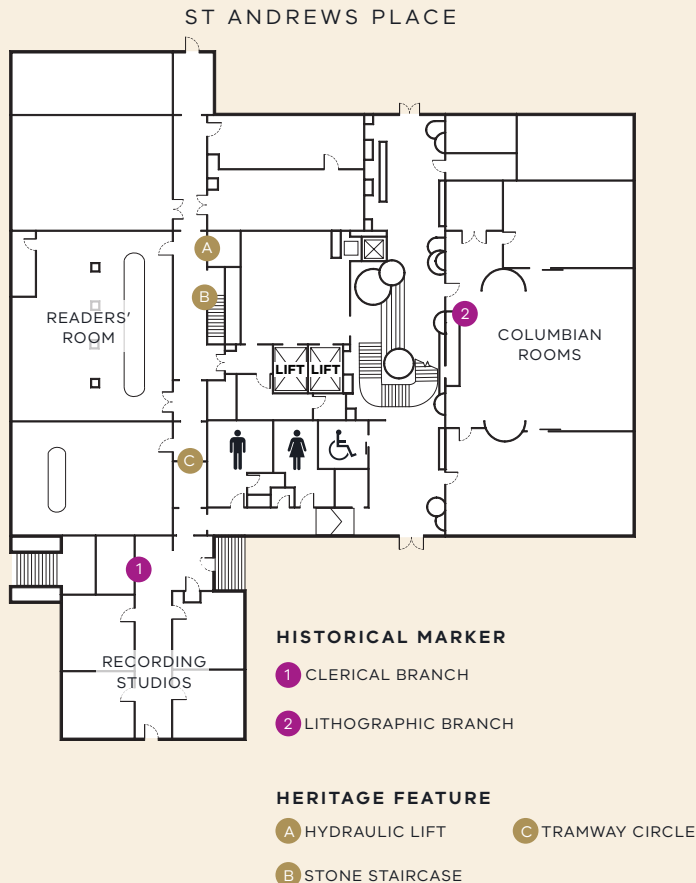

# Level One

ST ANDREWS PLACE

## Staff workspaces

The Academy's workspaces feature modern flexible working spaces, breakout areas, and videoconferencing.

This area was formerly the Warehousing Branch, where materials and documents were stored.

## Executive and meeting spaces

Reporting to a Board, the Academy is led by a CEO and executive team that occupy this space.

Previously the Government Printer's residence. The original staircase and structure of the rooms remains.

## Bastow Lounge and Learning Studio

Named after Henry Bastow, who was chief architect and surveyor for the Department of Education in the 1870s. This space is envisioned as the social heart of the building, a welcoming space that promotes community and interaction.

A feature of Learning Studio One is its rounded shape – pushing the boundaries of a traditional learning spaces.

Formerly the Bookbinders Branch, creating the handsome volumes turned out at the finish.

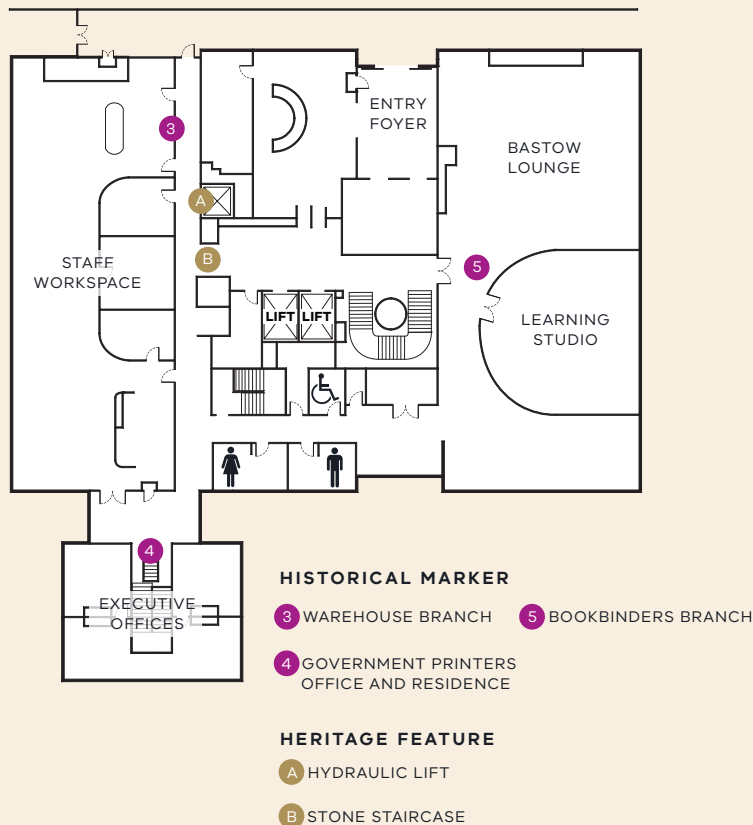

# Level Two

ST ANDREWS PLACE

## Learning studios

These two learning studios and raised platform allow for different teaching modes and breakout spaces.

Formerly the Confidential and Ruling Rooms, where examination papers were printed, all ruling was done, as was the gold lettering for railway tickets.

## Remote Learning Studios

These enable participants to join professional learning held off-site via videoconferencing facilities.

## Design Thinking Space

Features moveable writable surfaces that create diverse configurations of the room that supports teaching practice and brainstorming activities.

Formerly the Railway Ticket Branch, which printed 100 million tickets a year for the Railways Department.

## Academy Presentation Hall

The Academy Presentation Hall is a flexible presentation space for up to 200 guests and includes a mini amphitheatre.

This space was formerly the Folding Room, where printed materials were cut and folded before being bound.

